

STEPS

(1) Hardware

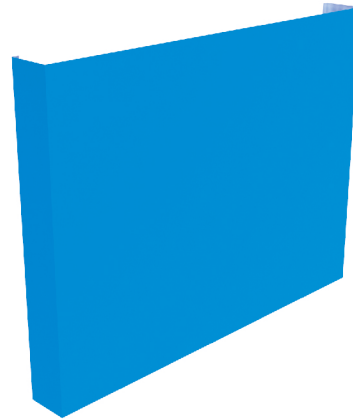

(2) Fabric banner



STEP 01

Expand the frame from diagonal to shape. To align the green locking pieces up & down and clip together.

PLEASE NOTE

Make sure to loosen all green locking pieces before folding up pop up frame.

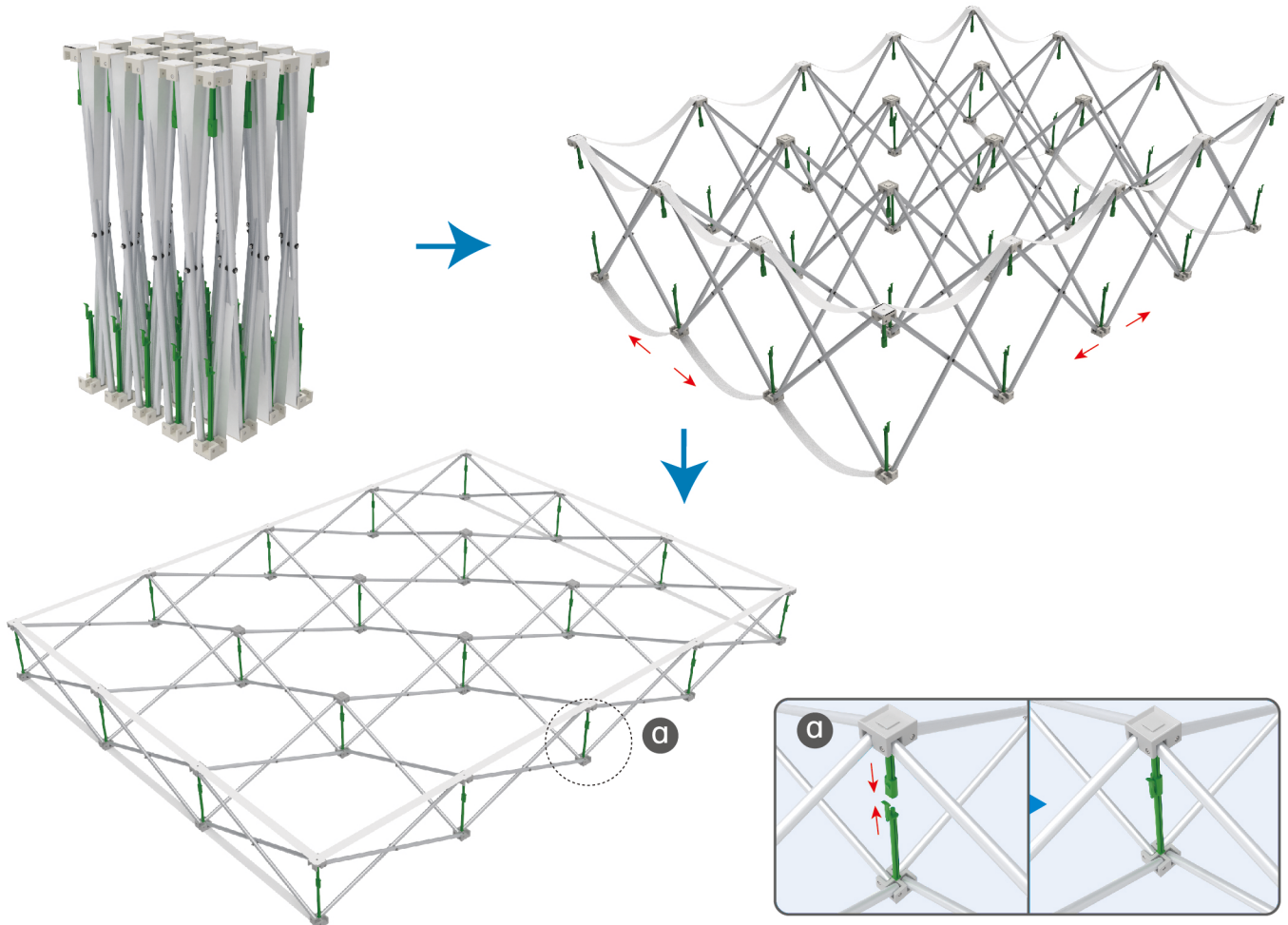

STEPS

STEP 02 To attach the fabric banner from side to side and then attach the end caps.

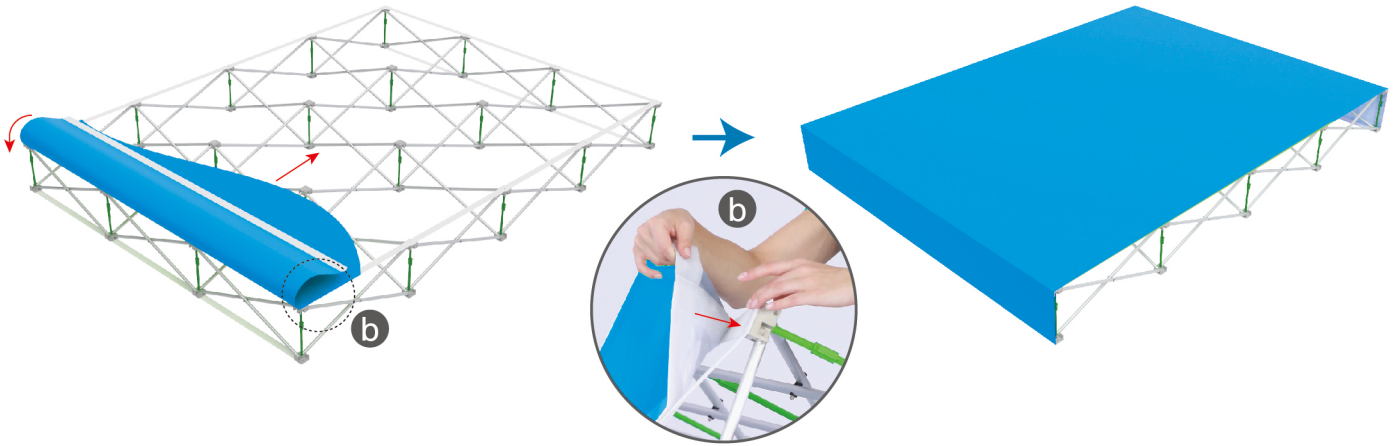

STEP 03 To slide the LED light at top of frame in position (2 of the plastic pieces at top are with slots for the lights)

LED Lights are optional

